

# technical sheet

## Bravo™ AC Lever hoist W.L.L.\*: 250 and 500 kg

ref. : T2437 GB  
rev. n° : -  
date : 06/14  
page : 1/1

### Characteristics:

- compact design unit and light-weight,
  - coating : paint,
  - aluminium casing,
  - load chain coated,
  - hooks rotating 360° labeled with hoist W.L.L.\* fitted with safety latches removable,
  - standard lifting height: 1.5m. Other possible lifting heights : see table below,
  - unit designed and built to withstand dynamic testing at 1.1 x W.L.L.\* and static testing at 1.5 x W.L.L.\*,
  - unit designed to ensure a minimum mechanical strength of 4 x W.L.L.\*,
  - unit complies with directive 2006/42/CE requirements.
- \* : Working Load Limit.

Note: The Bravo™ AC hoists cannot be fitted with a load limiter

### Technical specifications:

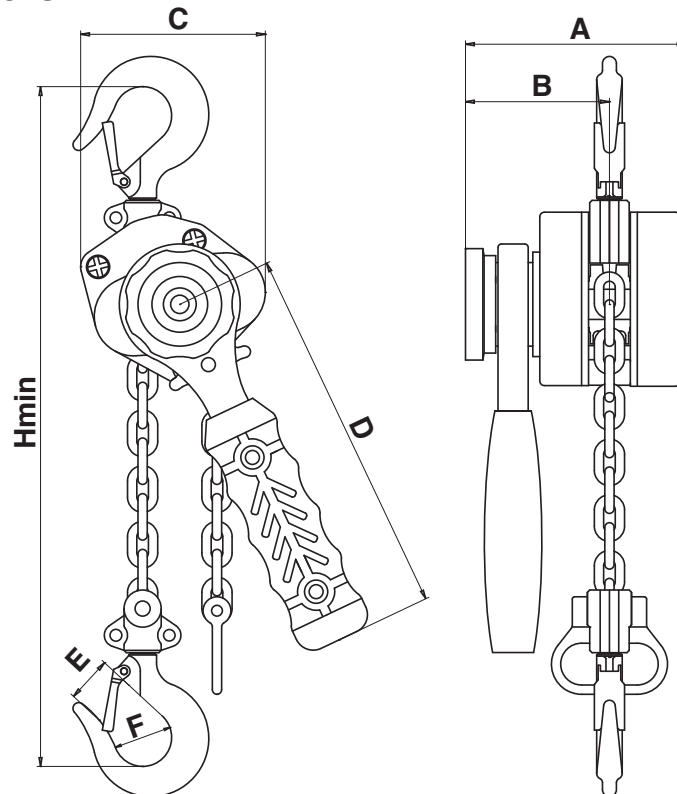

W.L.L.* kg	Standard lifting height** m	Number of strands	Maximum force on handle at WLL daN	Weight*** kg	Chain dimensions Øx P (see fig.1) mm	Additional weight by lifting m kg	Dimensions mm						
							A	B	C	D	E	F	H mini
250	1.5	1	17	2.3	4x12	0.35	100	61	80	160	23	32	230
500	1.5	1	19	3.3	5x15	0.56	110	68	100	160	25	34	270

\* Working Load Limit.

\*\* others travel distances possible : 3 meters.

\*\*\* with lifting chain.

